



asber 

*Easy & Tech Line*

*Glass & Dish Washers*





# EASY LINE DISHWASHERS

## FEATURES:

- High grade 304 stainless steel construction
- Pressed tank and rounded corners to aid cleaning of machine
- Double skin door for quieter running and improved efficiency
- Rotating wash and rinse arms removable for cleaning
- Automatic detergent and rinse aid dosing
- Fixed 120 second wash cycle (90/180 second cycle on pass through)
- Adjustable wash and rinse thermostats
- Anti-backflow valve fitted
- ¾" BSP water inlet hose included
- Gravity and integral drain pump models available

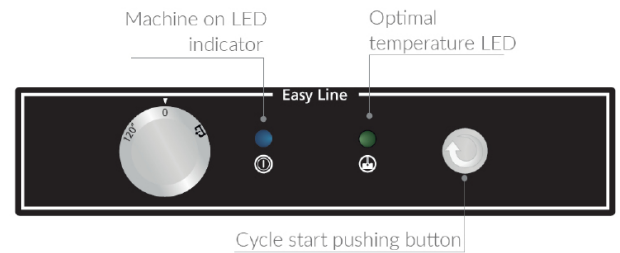

Control Panel



Model	GE400BDDUK	GE500DDUK	GEH500BDD
Description	Under counter dishwasher with integral detergent, rinseaid pumps and optional drain pump	Under counter dishwasher with integral detergent, rinseaid pumps and optional drain pump	Pass through dishwasher with drain pump, integral detergent and rinseaid pumps
Basket Size (mm)	400	500	500
External Dimensions (H x W x D mm)	720 x 470 x 525	820 x 600 x 600	1960 x 675 x 675
Internal basket height clearance	270	320	420
Cycle Times	120 secs	120 secs	90/180 secs
Water Usage	2.1 Litre per cycle	2.71 Litre per cycle	3.01 Litre per cycle
Power Consumption	2.7 kW	2.8 kW	11.1 kW
Power Supply	13A plug	13A plug	Hard wired
Configurable Power Supply	No	No	17.8A (3 Phase) or 28.8A (1 Phase)
Break Tank	WRAS Non Return Valve	WRAS Non Return Valve	WRAS Non Return Valve
Drain Pump	Optional	Optional	Yes
Supplied with	2x 400mm dishwasher baskets 1x cutlery basket insert	2x 500mm dishwasher baskets 1x cutlery basket insert	2x 500mm dishwasher baskets 1x cutlery insert basket



# EASY LINE GLASSWASHERS

## Easy cleaning & maintenance

Easy to clean interior with rounded corners in wash tank, removable wash and rinse arms and specially designed wash filter (catches and contains debris within bottom flange). Reducing the risk of debris falling into the wash pump or drain when the filter is removed for cleaning.

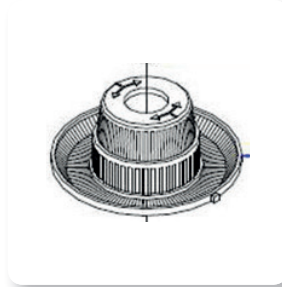

## Recessed door handle

Ergonomically designed door handle for easy opening and a flush finish.



Model	GE350DDUK	GE400DDUK	GE500DDUK
Description	Under counter glasswasher with integral detergent and rinseaid pumps	Under counter glasswasher with integral detergent, rinseaid pumps and optional drain pump	Under counter glasswasher with integral detergent, rinseaid pumps and optional drain pump
Basket Size (mm)	350	400	500
External Dimensions (H x W x D mm)	660 x 430 x 475	720 x 470 x 525	820 x 600 x 600
Internal basket height clearance	220	270	320
Cycle Times	120 secs	120 secs	120 secs
Water Usage	2.1 Litre per cycle	2.5 Litre per cycle	2.71 Litre per cycle
Power Consumption	2.7 kW	2.7 kW	2.8 kW
Power Supply	13A plug	13A plug	13A plug
Configurable Power Supply	No	No	No
Break Tank	WRAS Non Return Valve	WRAS Non Return Valve	WRAS Non Return Valve
Drain Pump	Optional	Optional	Optional
Supplied with	2x 350mm glasswasher baskets 1x cutlery basket insert	2x 400mm glasswasher baskets 1x cutlery basket insert	2x 500mm glasswasher baskets 1x cutlery insert basket



# TECH LINE GLASSWASHERS

## FEATURES:

- Full digital control panel
- Wash tank and boiler temperature display
- High grade 304 stainless steel construction
- Pressed tank and rounded corners to aid cleaning of machine
- Double skin door for quieter running and improved efficiency
- Rotating wash and rinse arms removable for cleaning
- Automatic detergent and rinse aid dosing
- 3 wash programmes: 90, 120 and 180 second
- Adjustable wash and rinse thermostats
- Anti-backflow valve fitted
- ¾" BSP water inlet hose included

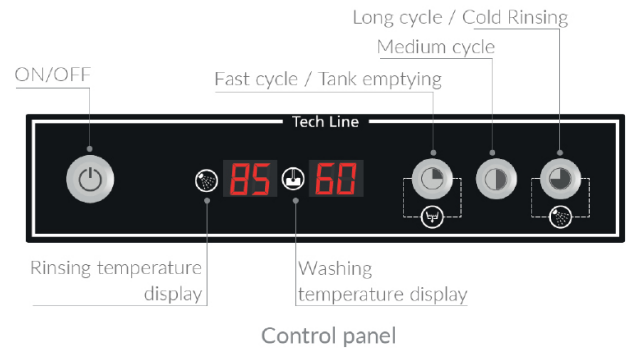

Model	GT400BDDUK	GT400BDDUKSOFT	GT500BDDUK
Description	Under counter glasswasher with drain pump, integral detergent and rinseaid pumps	Under counter glasswasher with water softener, drain pump, integral detergent and rinseaid pumps	Under counter glasswasher with drain pump, integral detergent and rinseaid pumps
Basket Size (mm)	400	400	500
External Dimensions (H x W x D mm)	720 x 470 x 525	720 x 470 x 525	820 x 600 x 600
Internal basket height clearance	270	270	320
Cycle Times	90/120/180 secs	90/120/180 secs	90/120/180 secs
Water Usage	2.5 Litre per cycle	2.5 Litre per cycle	2.71 Litre per cycle
Power Consumption	2.5 kW	2.5 kW	2.8 kW
Power Supply	13A plug	13A plug	13A plug
Configurable Power Supply	No	No	No
Break Tank	WRAS Non Return Valve	WRAS Non Return Valve	WRAS Non Return Valve
Drain Pump	Yes	Yes	Yes
Supplied with	2x 400mm glasswasher baskets 1x cutlery basket insert	2x 400mm glasswasher baskets 1x cutlery basket insert	2x 500mm glasswasher baskets 1x cutlery insert basket

## Easy cleaning & maintenance

Easy to clean interior with rounded corners in wash tank, removable wash and rinse arms and specially designed wash filter (catches and contains debris within bottom flange). Reducing the risk of debris falling into the wash pump or drain when the filter is removed for cleaning.



## Recessed door handle

Ergonomically designed door handle for easy opening and a flush finish.



Model	GT500BDDUKSOFT	GT510BDDUK	GT510BDDUKSOFT
Description	Under counter glasswasher with water softener, drain pump, integral detergent and rinseaid pumps	Under counter high power glasswasher with drain pump, integral detergent and rinseaid pumps	Under counter highpower glasswasher with water softener, drain pump, integral detergent and rinseaid pumps
Basket Size (mm)	500	500	500
External Dimensions (H x W x D mm)	820 x 600 x 600	820 x 600 x 600	820 x 600 x 600
Internal basket height clearance	320	320	320
Cycle Times	90/120/180 secs	90/120/180 secs	90/120/180 secs
Water Usage	2.71 Litre per cycle	2.71 Litre per cycle	2.71 Litre per cycle
Power Consumption	2.8 kW	6.2 kW	6.2 kW
Power Supply	13A plug	Hard wired	Hard wired
Configurable Power Supply	No	10.7A (3 Phase) or 27A (1 Phase)	10.7A (3 Phase) or 27A (1 Phase)
Break Tank	WRAS Non Return Valve	WRAS Non Return Valve	WRAS Non Return Valve
Drain Pump	Yes	Yes	Yes
Supplied with	2x 500mm glasswasher baskets 1x cutlery insert basket	2x 500mm glasswasher baskets 1x cutlery insert basket	2x 500mm glasswasher baskets 1x cutlery insert basket





# TECH LINE DISHWASHERS

## FEATURES:

- Full digital control panel
- Wash tank and boiler temperature display
- High grade 304 stainless steel construction
- Pressed tank and rounded corners to aid cleaning of machine
- Double skin door for quieter running and improved efficiency
- Rotating wash and rinse arms removable for cleaning
- Automatic detergent and rinse aid dosing
- 3 wash programmes: 90, 120 and 180 second
- Adjustable wash and rinse thermostats
- Anti-backflow valve fitted
- ¾" BSP water inlet hose included



Model	GT400BDDUK	GT400BDDUKSOFT	GT500BDDUK	GT500BDDUKSOFT
Description	Under counter dishwasher with drain pump, integral detergent and rinseaid pumps	Under counter dishwasher with water softener, drain pump, integral detergent and rinseaid pumps	Under counter dishwasher with drain pump, integral detergent and rinseaid pumps	Under counter dishwasher with water softener, drain pump, integral detergent and rinseaid pumps
Basket Size (mm)	400	400	500	500
External Dimensions (H x W x D mm)	720 x 470 x 525	720 x 470 x 525	820 x 600 x 600	820 x 600 x 600
Internal basket height clearance	270	270	320	320
Cycle Times	90/120/180 secs	90/120/180 secs	90/120/180 secs	90/120/180 secs
Water Usage	2.5 Litre per cycle	2.5 Litre per cycle	2.71 Litre per cycle	2.71 Litre per cycle
Power Consumption	2.5 kW	2.5 kW	2.8 kW	2.8 kW
Power Supply	13A plug	13A plug	13A plug	13A plug
Configurable Power Supply	No	No	No	No
Break Tank	WRAS Non Return Valve	WRAS Non Return Valve	WRAS Non Return Valve	WRAS Non Return Valve
Drain Pump	Yes	Yes	Yes	Yes
Supplied with	2x 400mm dishwasher baskets 1x cutlery basket insert	2x 400mm dishwasher baskets 1x cutlery basket insert	2x 500mm dishwasher baskets 1x cutlery basket insert	2x 500mm dishwasher baskets 1x cutlery basket insert

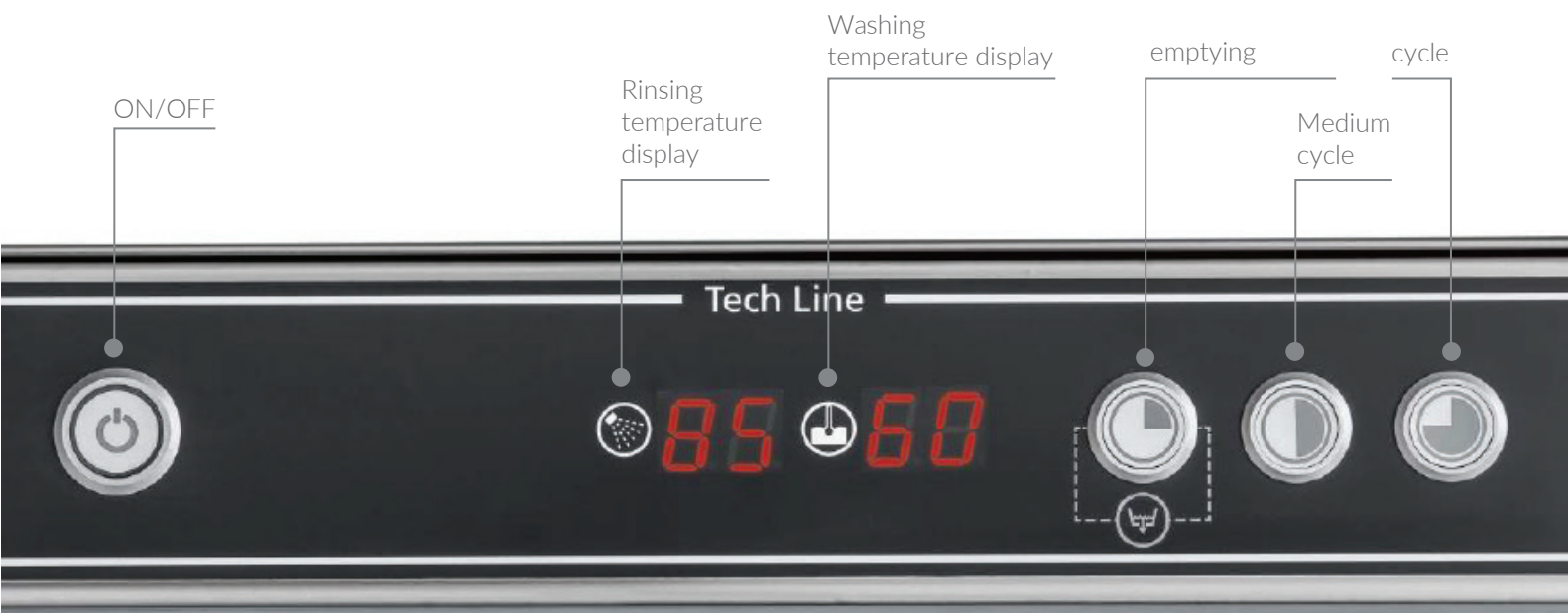

Model	GT500WBDDUK	GT510BDDUK	GT510BDDUKSOFT	GT510WBDDUK
Description	Under counter dishwasher with break tank, water softener, drain pump, integral detergent and rinseaid pumps	High power under counter dishwasher with drain pump, integral detergent and rinseaid pumps	High power under counter dishwasher with water softener, drain pump, integral detergent and rinseaid pumps	High power under counter dishwasher with break tank, water softener, drain pump, integral detergent and rinseaid pumps
Basket Size (mm)	500	500	500	500
External Dimensions (H x W x D mm)	820 x 600 x 600	820 x 600 x 600	820 x 600 x 600	820 x 600 x 600
Internal basket height clearance	320	320	320	320
Cycle Times	90/120/180 secs	90/120/180 secs	90/120/180 secs	90/120/180 secs
Water Usage	2.71 Litre per cycle	2.71 Litre per cycle	2.71 Litre per cycle	2.71 Litre per cycle
Power Consumption	2.8 kW	6.2 kW	6.2 kW	6.2 kW
Power Supply	13A plug	Hard wired	Hard wired	Hard wired
Configurable Power Supply	No	27A (1 Phase)	10.7A (3 Phase) or 27A (1 Phase)	10.7A (3 Phase) or 27A (1 Phase)
Break Tank	WRAS Type A Air Gap	WRAS Non Return Valve	WRAS Non Return Valve	WRAS Type A Air Gap
Drain Pump	Yes	Yes	Yes	Yes
Supplied with	2x 500mm dishwasher baskets 1x cutlery basket insert	2x 500mm dishwasher baskets 1x cutlery basket insert	2x 500mm dishwasher baskets 1x cutlery basket insert	2x 500mm dishwasher baskets 1x cutlery basket insert



# TECH LINE PASS THROUGH DISHWASHERS

## FEATURES:

- Full digital control panel
- Wash tank and boiler temperature display
- High grade 304 stainless steel construction
- Pressed tank and rounded corners to aid cleaning of machine
- Double skin door for quieter running and improved efficiency
- Rotating wash and rinse arms removable for cleaning
- Automatic detergent and rinse aid dosing
- 3 wash programmes: 90, 120 and 180 second
- Adjustable wash and rinse thermostats
- Anti-backflow valve fitted
- WRAS approved 'Type A' Break Tank
- ¾" BSP water inlet hose included

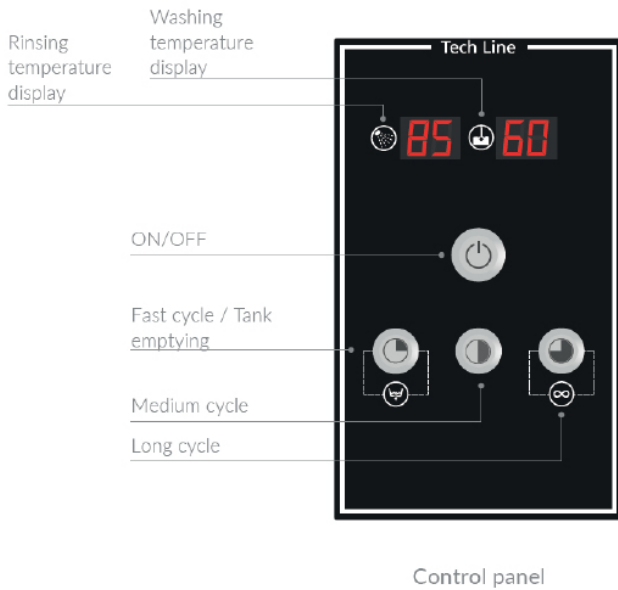

## DURABILITY



## ERGONOMIC



## HIGH PERFORMANCE



## EASY SET UP AND OPERATION

Model	GTH500WBDD	GTH510WBDD
Description	Pass through dishwasher with break tank, drain pump, integral detergent and rinseaid pumps	High power pass through dishwasher with break tank, drain pump, integral detergent and rinseaid pumps
Basket Size (mm)	500	500
External Dimensions (H x W x D mm)	1960 x 675 x 675	1960 x 675 x 675
Internal basket height clearance	420	420
Cycle Times	90/120/180 secs	90/120/180 secs
Water Usage	2.71 Litre per cycle	2.71 Litre per cycle
Power Consumption	11.1 kW	17.7 kW
Power Supply	Hard wired	Hard wired
Configurable Power Supply	9.25A (3 Phase) or 28.8A (1 Phase)	14.75A (3 Phase)
Break Tank	WRAS Type A Air Gap	WRAS Type A Air Gap
Drain Pump	Yes	Yes
Supplied with	2x 500mm dishwasher baskets 1x cutlery basket insert	2x 500mm dishwasher baskets 1x cutlery basket insert





#### IMPORTANT NOTE

If you are installing a glass or dishwasher in a hard water area, we recommend you to fit a water softener. Faults attributed to poor water quality are not covered under the manufacturer's warranty.

RECOMMENDED ACCESSORIES	
Manual Water Softener	PRWS12
Automatic Water Softener	MJR02
Water Inlet Hose	BLUEHOSE
Cutlery Basket Insert	Q902314
350 x 350mm Glass Basket	Q902000
400 x 400mm Glass Basket	Q902004
500 x 500mm Glass Basket	Q902007
400 x 400mm Plate Basket	69241
500 x 500mm Plate Basket	PR
Universal Stand	Q902100
Glasswash Detergent	EP052
Dishwash Detergent	EP058
Dishwash/Glasswash Rinse Aid	EP055



2 YEARS PARTS



1 YEAR LABOUR

Exclusively imported by



**Address:** Buzz Supplies Ltd, Woodside Industrial Estate, Dunmow Road, Bishops Stortford, Hertfordshire, CM23 5QQ

**Telephone:** 01279 876500

**Email:** [sales@buzzsupplies.co.uk](mailto:sales@buzzsupplies.co.uk)

**Website:** [www.buzzcatering supplies.com](http://www.buzzcatering supplies.com)