

Food Warming Drawers

Key Features

- Type: Electric
- Counter top unit
- Pre-set thermostat
- Water tray (removable)
- Two drawers (removable)
- Supplied with 2 x 1/1 GN containers (100mm deep) and perforated tray



FWDG

Construction

- Body: stainless steel grade 430
- GN containers: stainless steel grade 304

Available Options

- N/A

Available Accessories

- N/A

Specifications

| Model | FWDG |
|---|-----------------|
| External height (mm) | 485 |
| External width (mm) | 620 |
| External depth (mm) | 585 |
| Usable drawer capacity h x w x d (mm) | 110 x 503 x 298 |
| Net weight unpacked (kg) | 47.5 |
| Gross weight packed (kg) | 52 |
| Shipping volume (m ³) | 0.639 |
| Total power rating (kW) | 1.5 |
| Electrical supply 1N~+E 230V 50-60Hz Current Rating (A) | 6.5 |

FWDG

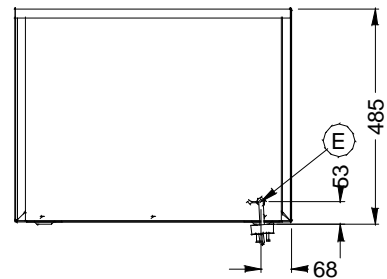
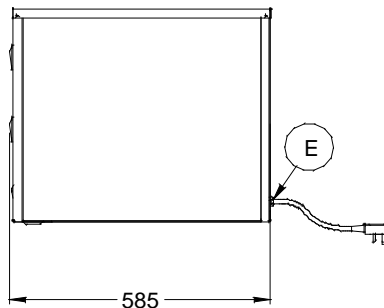
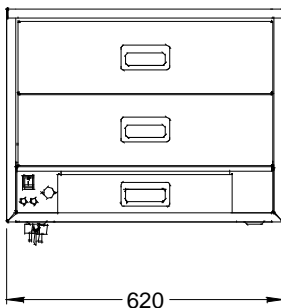
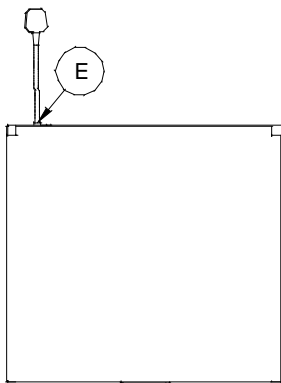

Lincat Limited, Whisby Road,
Lincoln LN6 3QZ,
United Kingdom

UK Sales Tel: 01522 875500 UK Spares Tel: 01522 875510 UK General Tel: 01522 875555
UK Fax: 01522 875530 International Sales Tel: +44 1522 503250 International Fax: +44 1522 875530
Website: www.lincat.co.uk UK Sales e-mail: sales@lincat.co.uk International Sales e-mail: export@lincat.co.uk



Document ref:
FOODWARMING
Issue date: Oct-09