



DF4/P - Lincat Silverlink 600 Propane Gas Counter-top Single Tank Fryer - 2 Baskets - W 450 mm - 10.5 kW

The Silverlink 600 Gas Single Tank Counter Top Fryer delivers 25kg of chips per hour, while it also features a twin basket operation which gives you the flexibility of cooking different foods or loads simultaneously.

- ✓ Single tank fryer with twin basket operation giving you the flexibility to cook different foods or loads simultaneously, delivering 25kg of chips per hour
- ✓ Front mounted controls for safety
- ✓ Thermostatically controlled to give accurate cooking temperatures throughout cooking. Flame failure device and top temperature cut out ensures safe operation.
- ✓ Cool zone collects cooking debris - gives cleaner cooking results and saves money by prolonging the life of the oil
- ✓ Piezo ignition for easy lighting
- ✓ Heavy duty nickel plated baskets for the most demanding of operations
- ✓ Front drain off tap for easy removal of cooking oil

Specifications

| Summary | | Power and Performance | |
|----------------------|-----------------------------------|-----------------------|------------|
| Brand | Lincat | BTU per Hour | 35,826 |
| Range | Silverlink 600 | Total Power kW | 10.5 |
| Power Type | Gas | Temperature Range °C | 110-190 |
| Gas Type | Propane Gas | Temperature Control | Mechanical |
| Unit Type | Counter-top | | |
| Available in UK Only | No | | |
| UK Warranty | 2 Years Parts and Labour Warranty | | |
| Export Warranty | Contact your local dealer | | |
| GTIN | 5056105104612 | | |

| Key Specifications | | Capacity | |
|--------------------|---------------|-------------------------|---|
| Number of Baskets | 2 | Product Output per Hour | 16kg chips - 12mm [frozen], 25kg chips - 12mm [chi] |
| Number of Tanks | 1 | Capacity Litres | 8.0 |
| Gravity Filtration | No | | |
| Pumped Filtration | No | | |
| Drain Location | Front-mounted | | |

| Weights and Dimensions | | Supply Connections | |
|---------------------------|------|--|--------|
| Unit Height (External) mm | 415 | Requires Installation | Yes |
| Unit Width (External) mm | 450 | Requires Electrical Supply | No |
| Unit Depth (External) mm | 654 | Gas Connection BSP | 1/2" |
| Net Weight Kg | 30.9 | Gas Consumption at full rate Propane m³ per Hour | 0.75 |
| | | Gas Pressure Propane mbar | 35.0 |
| | | Total heat input at full rate Propane kW | 10.5 |
| | | Total heat input at full rate Propane BTU per hour | 38,600 |

Shipping

| | |
|------------------|-------|
| Packed Weight Kg | 33.99 |
| Packed Height cm | 63.5 |
| Packed Width cm | 70 |
| Packed Depth cm | 55 |

Available Accessories

| | |
|------|--|
| CH01 | Caterflex Hose 1/2" - 1 Metre - for use with units up to 66,000 BTU |
| CH02 | Caterflex Hose 1/2" - 1.5 Metre - for use with units up to 56,000 BTU |
| CN4 | Lincat Silverlink 600 Free-standing Ambient Open-Top Pedestal without Doors - W 450 mm |
| DC01 | DONUT CONV KIT DF4/GAS |
| SLS4 | Lincat Silverlink 600 Free-standing Floor Stand - for units W 450 mm |

Technical Picture

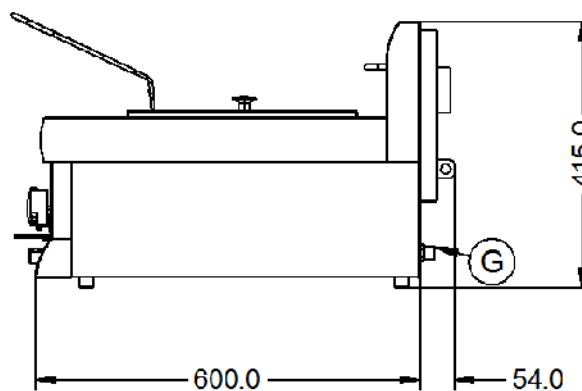
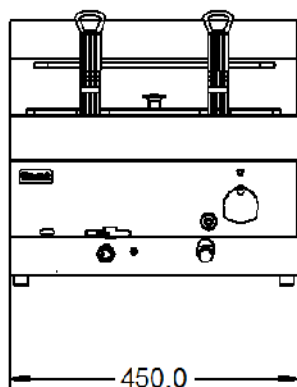
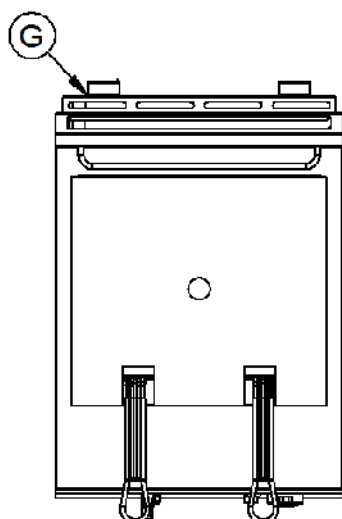



Lincat Limited

Whisby Road,
Lincoln, LN6 3QZ,
United Kingdom

Company No: 2175448

A member company of



Customer Care

Tel: +44 1522 875500

Email: care@lincat.co.uk

Export Customers

Tel: +44 1522 875536

Email: export@lincat.co.uk

Opening Hours

Monday – Friday:

8.30am – 5pm